

Important: Only use the cables and rechargeable batteries supplied in this box, or this product may not work. Any replacement rechargeable batteries must be of the same type.

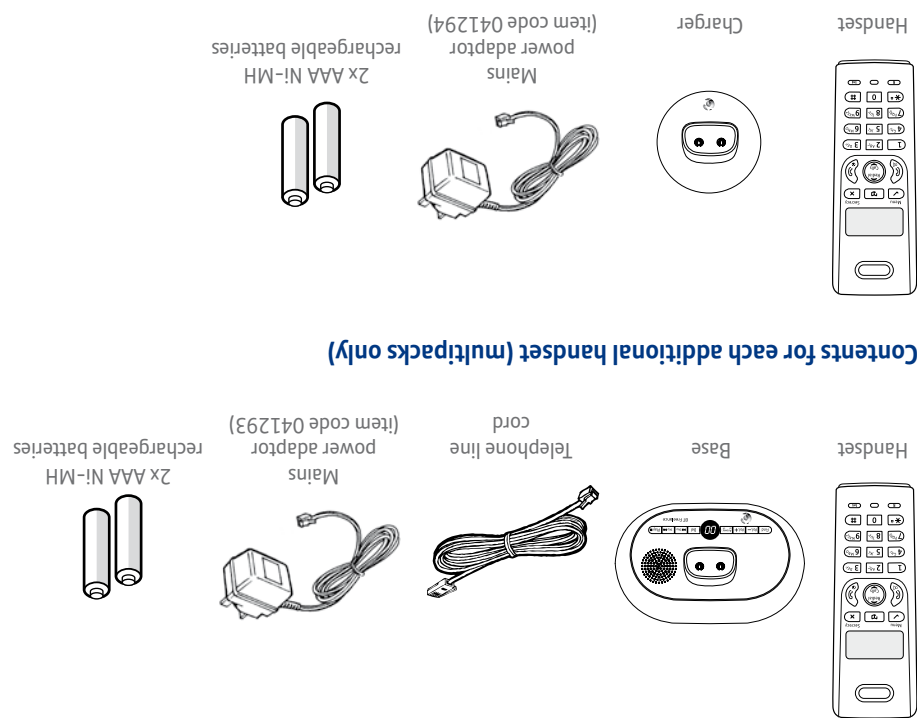

Check box contents

BT Freelance XC1500 User Guide



- 1 Plug in
- 2 Charge
- 3 Go!

Setting up is easy. Just follow the simple steps in this guide. If you need further assistance, please visit our website www.bt.com/producthelp to view our advanced user guide or call our helpdesk on **0808 100 6556***

* Calls made from within the UK mainland network are free. Mobile and International call costs may vary.

The answering machine will switch on and default to 'Answer and record' mode and the message counter will show 00.

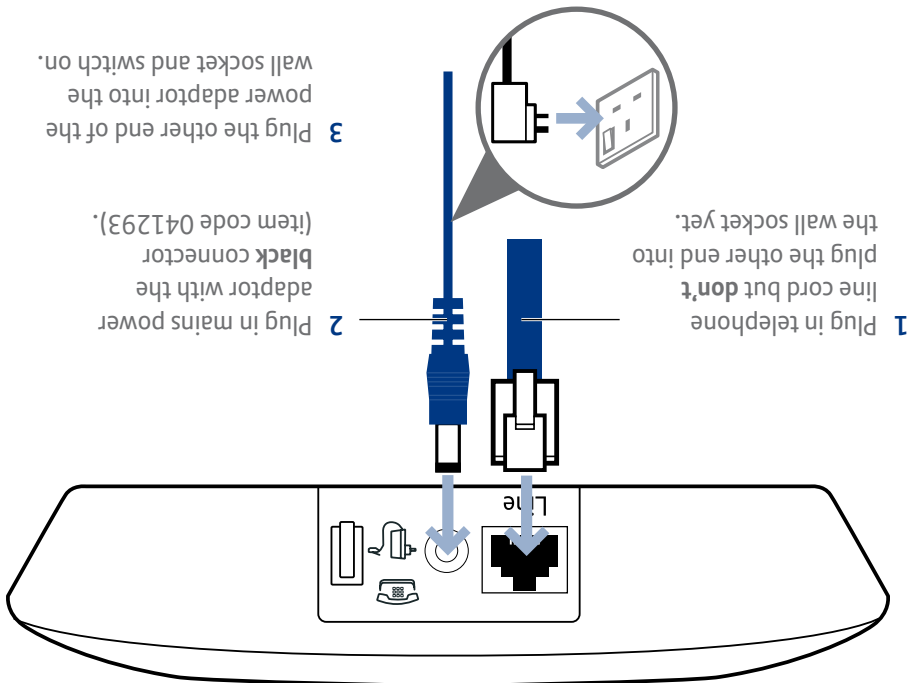

1 Plug in

2 Charge

- 1 For additional handsets and chargers: plug the mains power adaptor with the white connector (item code 041294) into the back of the charger and plug the other end into the mains wall socket and switch the power on.
 - 2 Insert batteries supplied as explained above.
 - 3 Place handset on the charger to charge for 24 hours.
- Set up your additional handsets (multipacks only)**

Important: Charge the handset batteries for 24 hours or your phone may not work.

- 1 Insert the two batteries supplied into the handset, observing the polarity markings inside the battery compartment, and slide the compartment cover shut.
- 2 Place handset on base to charge.
- 3 After 24 hours, plug the telephone line cord into the telephone wall socket.

General information

For information on safety instructions, cleaning, technical information or connecting to a switchboard, please refer to the 'General Information' section in the full user guide at www.bt.com/producthelp

Guarantee

Your BT Freelance XC1500 is guaranteed for a period of 12 months from the date of purchase.

Subject to the terms listed below, the guarantee will provide for the repair of, or at BT's or its agent's discretion the option to replace the BT Freelance XC1500, or any component thereof, (other than batteries), which is identified as faulty or below standard, or as a result of inferior workmanship or materials. Products over 28 days old from the date of purchase may be replaced with a refurbished or repaired product.

The conditions of this guarantee are:

- The guarantee shall only apply to defects that occur within the 12 month guarantee period.
- Proof of purchase is required.
- The equipment is returned to BT or its agent as instructed.

This guarantee does not cover any faults or defects caused by accidents, misuse, fair wear and tear, neglect, tampering with the equipment, or any attempt at adjustment or repair other than through approved agents.

This guarantee does not affect your statutory rights.

For further information within and outside the 12 month guarantee, please refer to the full user guide at www.bt.com/producthelp

Product disposal instructions

The symbol shown here and on the product means that the product is classed as Electrical or Electronic Equipment and should not be disposed with other household or commercial waste at the end of its working life.

The Waste of Electrical and Electronic Equipment (WEEE) Directive (2002/96/EC) has been put in place to recycle products using best available recovery and recycling techniques to minimise the impact on the environment, treat any hazardous substances and avoid the increasing landfill.

Product disposal instructions for residential users

When you have no further use for it, please remove any batteries and dispose of them and the product as per your local authority's recycling processes. For more information please contact your local authority or the retailer where the product was purchased.

Product disposal instructions for business users

Business users should contact their suppliers and check the terms and conditions of the purchase contract and ensure that this product is not mixed with other commercial waste for disposal.

R&TTE Directive & Declaration of Conformity

This product is intended for use within the UK for connection to the public telephone network and compatible switchboards.

This equipment complies with the essential requirements for the Radio Equipment and Telecommunications Terminal Equipment Directive (1999/5/EC).

Offices worldwide

The services described in this publication are subject to availability and may be modified from time to time. Services and equipment are supplied subject to British Telecommunications plc's respective standard conditions of contract. Nothing in this publication forms any part of a contract.

© British Telecommunications plc 2008.
Registered Office: 81 Newgate Street, London EC1A 7AJ.
Registered in England No. 1800000.

Designed and produced by The Art & Design Partnership Ltd.

Printed in China / Issue 3 / ADP10-08



Your BT Freelance XC1500 is now ready for use.

Your phone

Handset

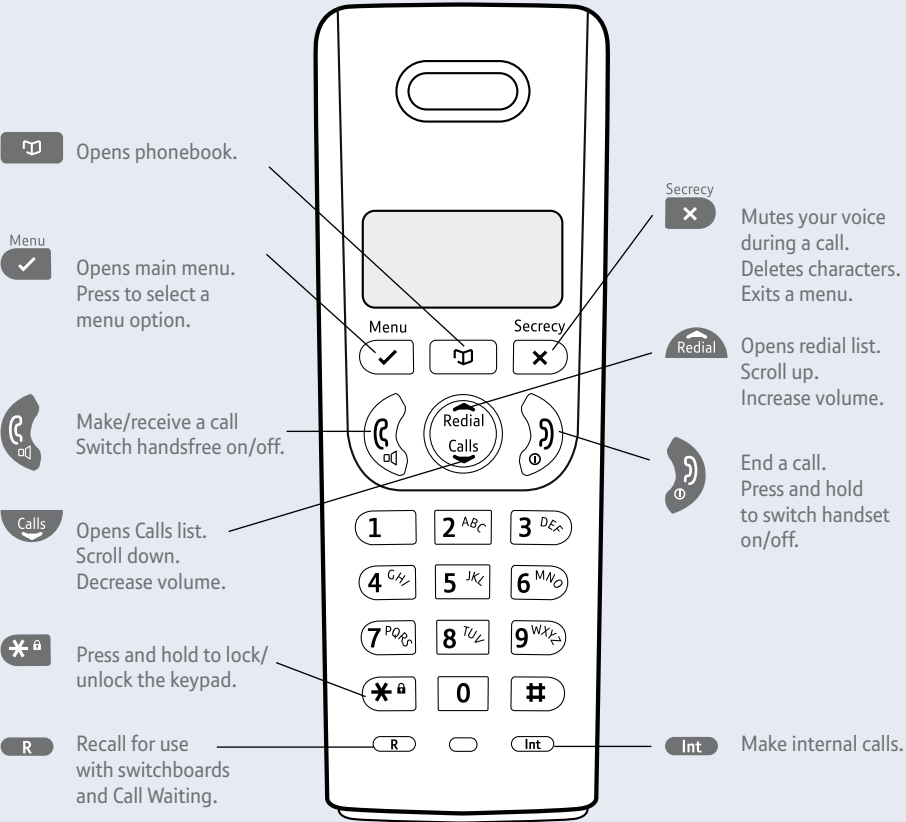

Base

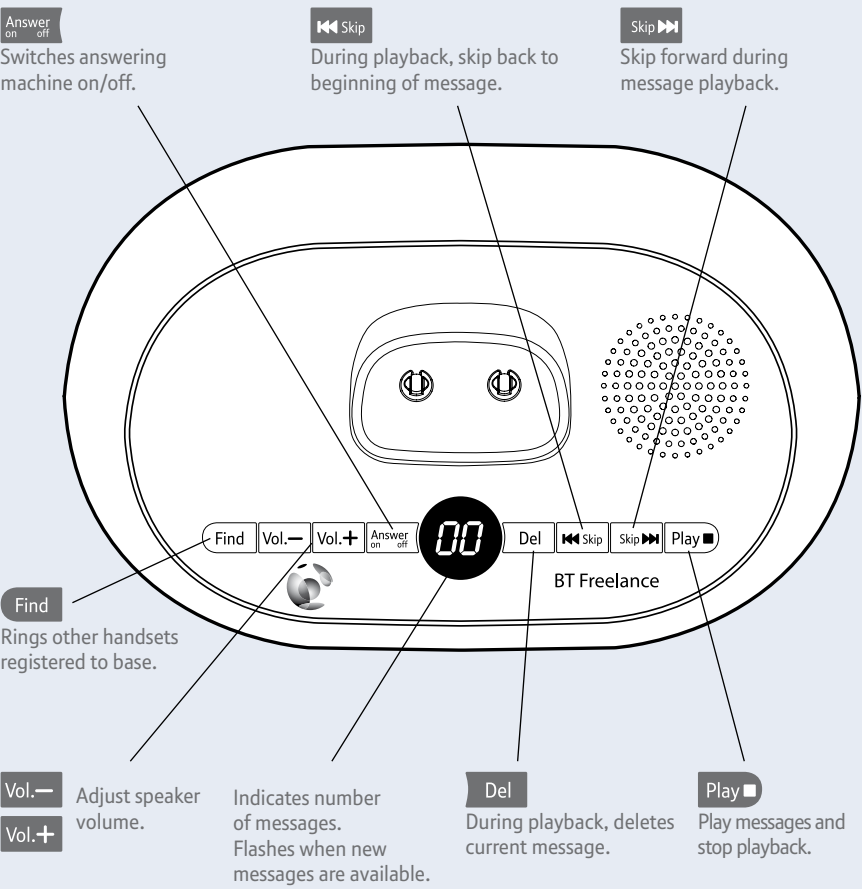

3 Go!

Set time and date

At the base, press **and hold** **Vol. -**. Current hour is announced and displayed. Press **Vol. +** or **Vol. -** to set the hour, then **Play** to confirm.

Press **Vol. +** or **Vol. -** to set the minute, then **Play** to confirm.

Press **Vol. +** or **Vol. -** to select **A** for AM or **P** for PM, then **Play** to confirm.

Press **Vol. +** or **Vol. -** to set the day.

Press **Play** to confirm. Full time and day will be announced.

You will need to set the handset time separately using the handset menu, see the full user guide online at www.bt.com/producthelp

Making calls

Press **Call** then dial the phone number. Press **End** to end the call.

Answering calls

If you have subscribed to Caller Display, the caller's details will be displayed before you answer (see below and also the full user guide online at www.bt.com/producthelp for details).

Lift the handset from the base or charger to answer incoming calls. If the handset is **not** on the base or charger, press **Call**.

Handsfree

Press **Call** during a call to switch call between earpiece and loudspeaker.

Secretcy

During a call, press **Secretcy**. MUTE is displayed and your caller cannot hear you. Press **Secretcy** to resume your call.

Redial

Press **Redial**, then scroll **Redial** or **Calls** to choose the number you want from the last 10 dialled numbers.

Press **Call** to redial the number.

Phonebook

Storing new phonebook entries (up to 50 entries)

Press **Menu**. PHONEBOOK is displayed, press **Menu**.

If entries already stored the first entry will be displayed, you'll need to press **Menu** again. Otherwise display shows ADD ENTRY. Press **Menu**.

Display shows ADD NAME. Using the letters on the keypad, enter the name. You may need to press the same button a few times until the letter you want is displayed. For example, press **2** once for **A**, or twice for **B**. Press **Menu**.

Display shows ADD NUMBER. Enter the phone number and press **Menu** to confirm.

Dialling a phonebook entry

Press **Menu**. Scroll **Calls** to the entry you want and press **Call** to dial.

Caller Display and the Calls list

You must subscribe to a Caller Display service for this feature to work. Your network provider may charge you for this service.

View and dial from the Calls list

Press **Calls**, then **Redial** or **Calls** to scroll through the last 40 incoming calls.

Press **#** repeatedly to switch between the number and date/time of the call.

Press **Call** to dial entry displayed.

Press **Menu** for further options.

Answering machine

Your answering machine is on and ready to record messages. The controls are shown in the base diagram on the bottom left.

Recording your own outgoing message

Press **and hold** **Skip**. After the long beep, speak your message close to the answering machine base.

Press **Play** to end recording. Your message is played back.

Setting the ring delay

Press and hold **Vol. +**. Current setting is announced.

Press **Vol. +** or **Vol. -** to set ring delay: 2–9 rings or tS (time saver). Press **Play** to confirm.

Now either change your remote access PIN or just wait for the base to return to standby.

Remote access

Switch on and listen to your messages remotely from another phone.

Switch on answer machine remotely

Dial you phone number, let it ring, after 20 rings your answering machine is switched on.

Operating answer machine from another phone

Dial your phone number, when you hear the outgoing message press *****. Enter your 3-digit PIN (default 000). Any new messages are announced and played.

Help

Most problems can be fixed with a few simple checks.

Problem	Solution
No dial tone	Only use the cables and batteries supplied. Make sure both the mains power adaptor cable and telephone line cord are plugged into the correct sockets.
Poor speech quality	Make sure the product is not located too close to other electrical appliances. This can also help improve the handset range from the base.
Battery icon not full/handset dead	Make sure you charge the batteries for 24 hours before use to ensure maximum battery performance.
Using broadband on the same phone line?	Make sure you plug the phone into the wall socket via an ADSL microfilter (not supplied), otherwise you may have problems with this product and your broadband service.

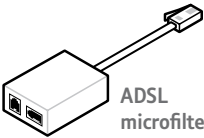

Find out more

- New Frequently Asked Questions available at www.bt.com/producthelp
- If you need more detailed instructions, a full user guide is available to download from www.bt.com/producthelp
- If you cannot find the answer to your problem in the full online user guide, then please call the Helpline on 0808 100 6556*. Our dedicated advisors are more likely to be able to help you than the retailer where you made your purchase.