

## Your BT2700 is now ready to use.

If you need to remove the batteries, place your fingers in the groove at the bottom of the handset and lift the cover up to release it. Then gently ease the batteries out.

**Set up your additional handsets (if you've bought a multipack)**

- For each additional handset and charger: plug the mains power adaptor into the socket on the underside of the charger, secure the cable behind the retaining clip and plug the other end into the wall power socket and switch on.
- Activate the batteries as shown above. Then place the handset on the charger to charge for 16 hours.

**Important:** you should charge the batteries for 16 hours before using the handset for the first time.

- Place the handset on the base to charge the batteries for 16 hours.
- Once found, follow the prompt to set the date and time.
- The handset will check for a link with the base station.
- Activate the batteries by pulling the plastic tab away from the bottom of the handset.

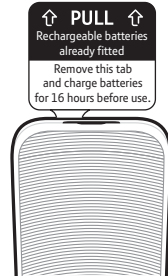

## 2 Charge

## Troubleshooting

Most problems can be fixed with a few simple checks.

Problem	Solution
No dial tone	Only use the cables supplied. Make sure the telephone line cord is plugged in correctly.
Handset not charging	Make sure the handset is turned on before placing on the base or charger to charge.
Phone ringer does not ring	The ringer volume may be set to Ringer off. Adjust the handset Ring volume. Check that Block mode or Do Not Disturb is not switched on.
Using broadband on the same phone line?	To avoid problems with your broadband or noise on your phone line, you might need to plug your telephone line cord into the wall via a microfilter (not supplied).  If your main phone socket has a single socket, as shown, you'll need to use microfilters.  You don't need to use microfilters if your main phone socket has two separate sockets, like either of these:

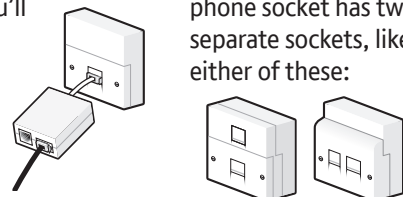

## General information

For information on safety instructions, cleaning, technical information or connecting to a switchboard, please refer to the 'General information' section in the full user guide at [bt.com/producthelp](http://bt.com/producthelp)

### Guarantee

Your BT2700 is guaranteed for a period of 12 months from the date of purchase.

Subject to the terms listed below, the guarantee will provide for the repair of, or at BT's or its agent's discretion the option to replace the BT2700, or any component thereof, (other than batteries), which is identified as faulty or below standard, or as a result of inferior workmanship or materials. Products over 28 days old from the date of purchase may be replaced with a refurbished or repaired product.

The conditions of this guarantee are:

- The guarantee shall only apply to defects that occur within the 12 month guarantee period.
- Proof of purchase is required.
- The equipment is returned to BT or its agent as instructed.

This guarantee does not cover any faults or defects caused by accidents, misuse, fair wear and tear, neglect, tampering with the equipment, or any attempt at adjustment or repair other than through approved agents.

This guarantee does not affect your statutory rights.

To find out what to do, if your phone is in or outside of the 12 month guarantee, please look in the full user guide at [bt.com/producthelp](http://bt.com/producthelp)

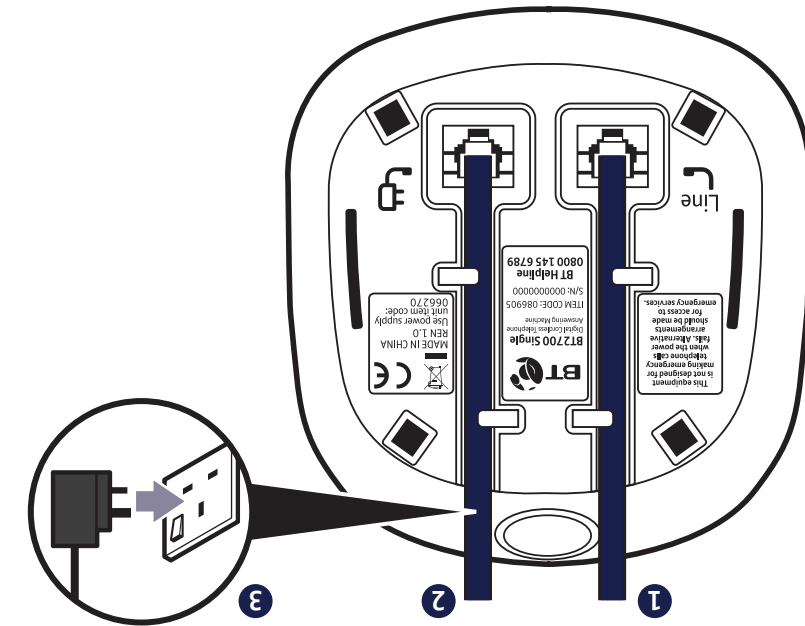

- The telephone line cord is already fitted, plug the other end into the wall socket.
- Plug the mains power adaptor into the base, with the cable clipped in the groove provided.
- Plug the other end of the power adaptor into the wall power socket and switch on.

## 1 Plug in



### How to recycle your equipment

The symbol shown here and on the product means that the product is classed as electrical or electronic equipment, so DO NOT put it in your normal rubbish bin.

It's all part of the Waste Electrical and Electronic Equipment (WEEE) Directive to recycle products in the best way – to be kinder to the planet, get rid of dangerous things more safely and bury less rubbish in the ground.

You should contact your retailer or supplier for advice on how to dispose of this product in an environmentally friendly way.

### Warning

You won't be able to call 999 from this phone if there's a power cut, so make sure you've got another way to call for help in an emergency.

### Radio Equipment Directive Declaration of Conformity

Hereby, British Telecommunications plc declares that the radio equipment type BT2700 Telephone (086905, 086906, 086907, 086908) is in compliance with Directive 2014/53/EU.

The full text of the EU declaration of conformity is available at the following internet address: [bt.com/producthelp](http://bt.com/producthelp)

### Radio transmission information

Frequency range 1881.792 – 1897.344MHz  
Max power 87.30mW 19.41dBm



## BT2700

## Digital Cordless Phone with Answer Machine

**Important:** Only use the mains power adaptors, cables and rechargeable batteries supplied in this box, or this product may not work. Any replacement rechargeable batteries must be the same type. BT accepts no responsibility for damage caused to your phone by using any other type of batteries.

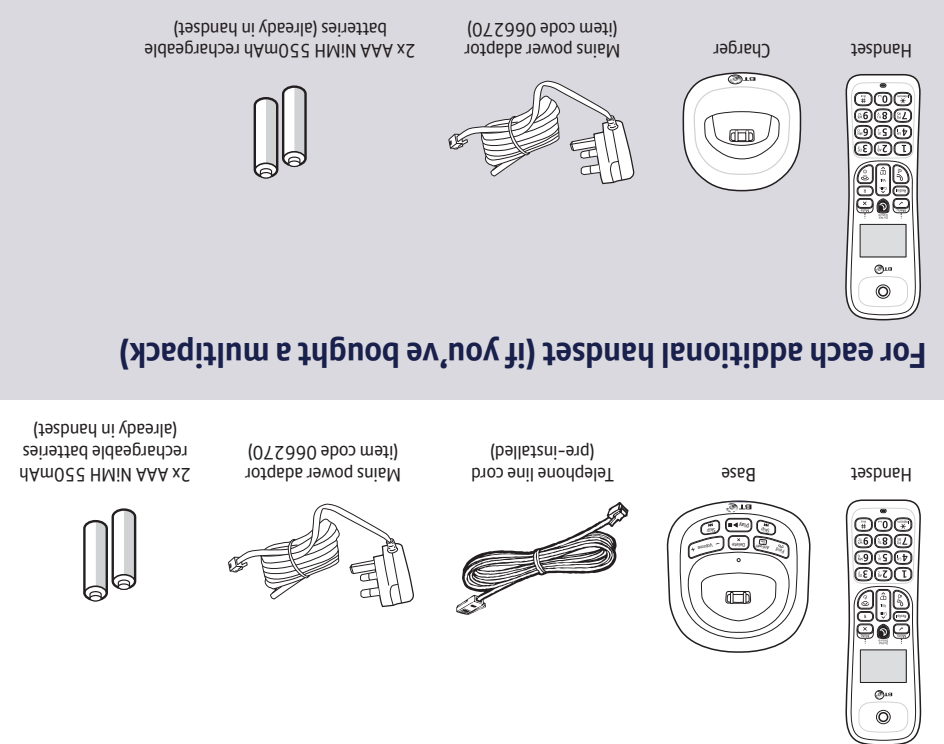

## What's in the box

For each additional handset (if you've bought a multipack)

# 3 Using your phone

## You'll need Caller Display

To get the most from your nuisance call blocker phone and for all the features to work, you'll need to subscribe to a Caller Display service from your network provider. Charges may apply.

## Making and receiving calls

**Make and end a call**  
Press green then dial the phone number. Press red to end the call.

**Answer a call**  
Press green when the phone is ringing.  
To answer a call without having to press , you can set Auto Pick-Up to On. To do this, press , scroll to **Personal Set**, press . Scroll to **Auto Pick-Up** and press . Scroll to **On** and press .

**Mute**  
Press during a call. Press to return to your caller.

## View or dial a number in Calls list†

The Calls list stores details of the last 50 incoming calls.  
1 Press , then . Press or to scroll through the list.  
2 Press to dial the number.

## Nuisance Call Blocking†

**Block an incoming call number in your Call list**  
1 Press to enter the **Call Log**. **Call List** is displayed, press . Then scroll to the entry you want to block and press .  
2 Scroll down to **Call Block**, press .

3 Screen will show the number that will be blocked. Press and number will be blocked as soon as call blocking is turned on following the instructions below.  
**Turn call blocking on to enable block list**  
1 Press , scroll to **Call Block** and press again. Enter default PIN 0000.  
2 Scroll to **Blacklist** and press . Then scroll to **Block mode** and press again.  
3 Scroll to **Block List** and press .

## Phonebook

**Store entry in phonebook (up to 50)**  
1 Press , scroll to **Phonebook** and press again. Scroll to **New Entry**, press .

**Dial entry in phonebook**  
1 From the home screen, press .

## Handset buttons and display icons

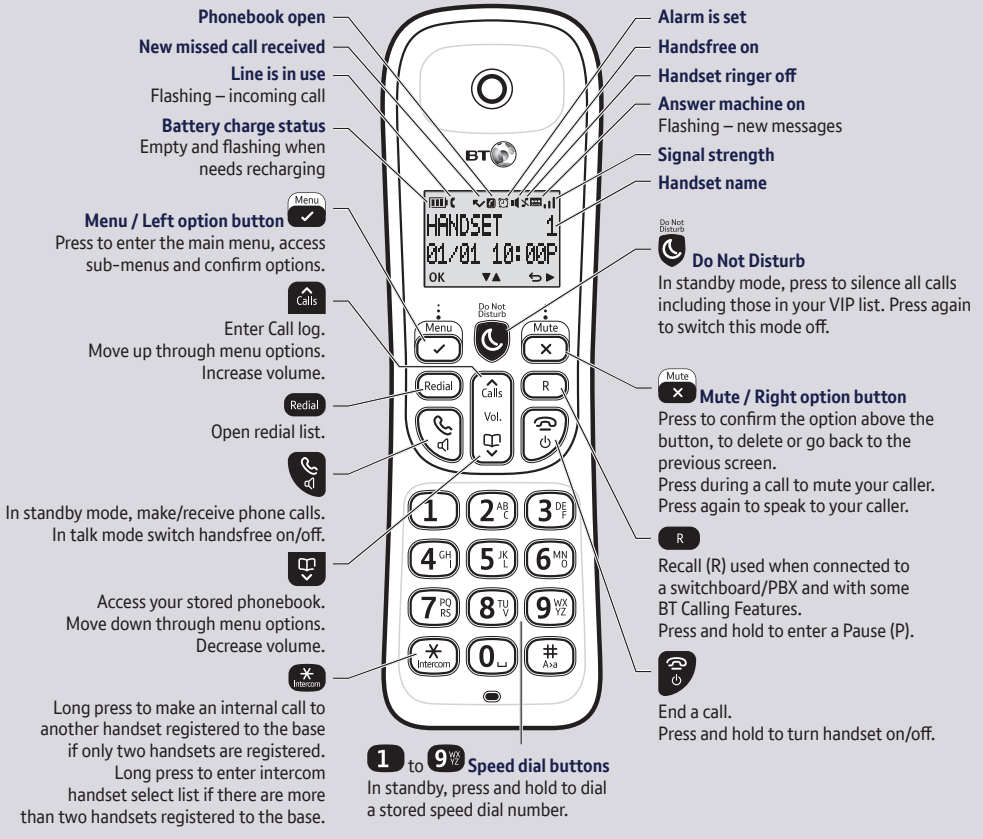

## Base buttons

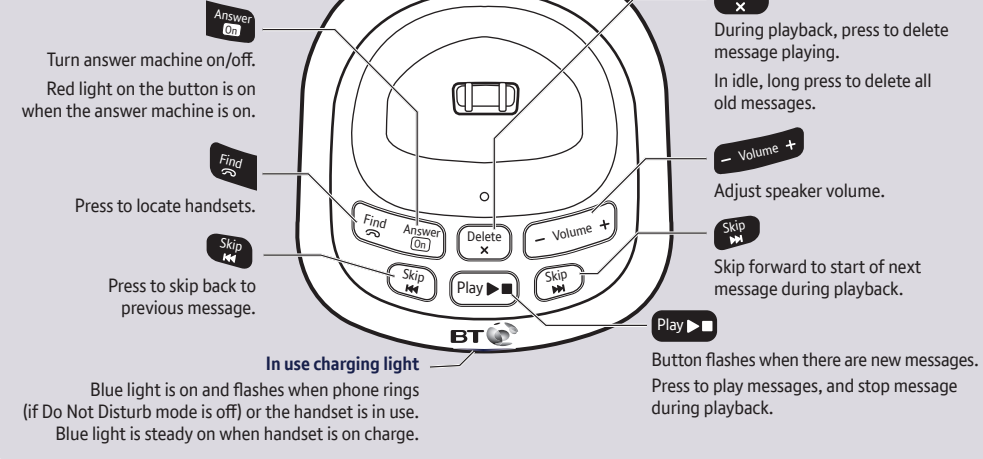

## Answer machine

Your answer machine is on and ready to record messages. You can control it using the buttons on the base (see above) or using the handset **Answ Machine** menu.

**Record your own outgoing message**  
1 Press . Press to display **Answ Machine**, press .

**Set the answer delay**  
For compatibility with BT1571 or another voicemail service make sure the answer delay is set to answer before the service, e.g. for BT1571 do not set to more than 5 rings.  
1 Press . Press to display **Answ Machine**, press .

## Using the menu

- Press to open the main menu, scroll through using or . When the menu you want is displayed, press . Press or to scroll through the sub menus and press to select.
- and buttons let you select options displayed above the buttons on the display.
- Use to exit a menu or go back.
- If no buttons are pressed for 30 seconds the handset will return to the idle screen.

## Handset volume and sounds

**Incoming speech volume**  
During a call, press or to increase or decrease the volume of your caller's voice.

**Handset ringer volume**  
1 Press , scroll to **Personal Set**, press .

**Handset ringtone**  
1 Press , scroll to **Personal Set**, press .

## Using the keypad

- When entering letters you may need to press the same button a few times until the letter you want is displayed, e.g. press **2<sup>AB</sup>** once for **A**, twice for **B**, three times for **C**.
- To enter a space, press **0<sup>SP</sup>**.
- To toggle between upper and lowercase characters, press and hold **#**.

## Need some help?

Frequently asked questions and a full user guide are available online.  
[bt.com/producthelp](http://bt.com/producthelp)  
If you cannot find the answer to your question in the full online user guide, call our free Helpline. Our dedicated advisors are more likely to be able to help you than the retailer where you bought your phone.  
**0800 145 6789\***  
This user guide is also available in other formats: large print, Braille and audio CD. Call the helpline for a copy.

\* Calls made from within the UK mainland network are free. Mobile and international call costs may vary.  
† Requires a subscription to a Caller Display service from your network provider. Charges may apply.